

PLAT No 5976

ENGINEER'S CERTIFICATE

We hereby certify that the plan shown hereon is correct, that it is a subdivision of part of the land conveyed by S.B. Elkins Inc. and The Leo Butler Company to Congressional Development Inc., by deed dated June 11, 1959, and recorded among the land records of Montgomery County Maryland in Liber 2610 of Folio 43; and that iron pipes marked thus \odot , and stakes marked thus \bullet are in place where shown.
Date: April 4, 1960

Kornegay Associates Inc

By: Rodney L. Hanson
Rodney L. Hanson
Reg. Land Surveyor, Md. #3034

CURVE		DATA			
STATION	ANGLE	CHORD	BEARING	CHORD	TO
17	100°00'	100.00	N 100° 00' E	100.00	18
18	100°00'	100.00	N 100° 00' E	100.00	19
19	100°00'	100.00	N 100° 00' E	100.00	20
20	100°00'	100.00	N 100° 00' E	100.00	21
21	100°00'	100.00	N 100° 00' E	100.00	22
22	100°00'	100.00	N 100° 00' E	100.00	23
23	100°00'	100.00	N 100° 00' E	100.00	24
24	100°00'	100.00	N 100° 00' E	100.00	25
25	100°00'	100.00	N 100° 00' E	100.00	26
26	100°00'	100.00	N 100° 00' E	100.00	27
27	100°00'	100.00	N 100° 00' E	100.00	28
28	100°00'	100.00	N 100° 00' E	100.00	29
29	100°00'	100.00	N 100° 00' E	100.00	30
30	100°00'	100.00	N 100° 00' E	100.00	31
31	100°00'	100.00	N 100° 00' E	100.00	32
32	100°00'	100.00	N 100° 00' E	100.00	33
33	100°00'	100.00	N 100° 00' E	100.00	34
34	100°00'	100.00	N 100° 00' E	100.00	35
35	100°00'	100.00	N 100° 00' E	100.00	36
36	100°00'	100.00	N 100° 00' E	100.00	37
37	100°00'	100.00	N 100° 00' E	100.00	38
38	100°00'	100.00	N 100° 00' E	100.00	39
39	100°00'	100.00	N 100° 00' E	100.00	40
40	100°00'	100.00	N 100° 00' E	100.00	41
41	100°00'	100.00	N 100° 00' E	100.00	42
42	100°00'	100.00	N 100° 00' E	100.00	43
43	100°00'	100.00	N 100° 00' E	100.00	44
44	100°00'	100.00	N 100° 00' E	100.00	45
45	100°00'	100.00	N 100° 00' E	100.00	46
46	100°00'	100.00	N 100° 00' E	100.00	47
47	100°00'	100.00	N 100° 00' E	100.00	48
48	100°00'	100.00	N 100° 00' E	100.00	49
49	100°00'	100.00	N 100° 00' E	100.00	50
50	100°00'	100.00	N 100° 00' E	100.00	51
51	100°00'	100.00	N 100° 00' E	100.00	52
52	100°00'	100.00	N 100° 00' E	100.00	53
53	100°00'	100.00	N 100° 00' E	100.00	54
54	100°00'	100.00	N 100° 00' E	100.00	55
55	100°00'	100.00	N 100° 00' E	100.00	56
56	100°00'	100.00	N 100° 00' E	100.00	57
57	100°00'	100.00	N 100° 00' E	100.00	58
58	100°00'	100.00	N 100° 00' E	100.00	59
59	100°00'	100.00	N 100° 00' E	100.00	60
60	100°00'	100.00	N 100° 00' E	100.00	61
61	100°00'	100.00	N 100° 00' E	100.00	62
62	100°00'	100.00	N 100° 00' E	100.00	63
63	100°00'	100.00	N 100° 00' E	100.00	64
64	100°00'	100.00	N 100° 00' E	100.00	65
65	100°00'	100.00	N 100° 00' E	100.00	66
66	100°00'	100.00	N 100° 00' E	100.00	67
67	100°00'	100.00	N 100° 00' E	100.00	68
68	100°00'	100.00	N 100° 00' E	100.00	69
69	100°00'	100.00	N 100° 00' E	100.00	70
70	100°00'	100.00	N 100° 00' E	100.00	71
71	100°00'	100.00	N 100° 00' E	100.00	72
72	100°00'	100.00	N 100° 00' E	100.00	73
73	100°00'	100.00	N 100° 00' E	100.00	74
74	100°00'	100.00	N 100° 00' E	100.00	75

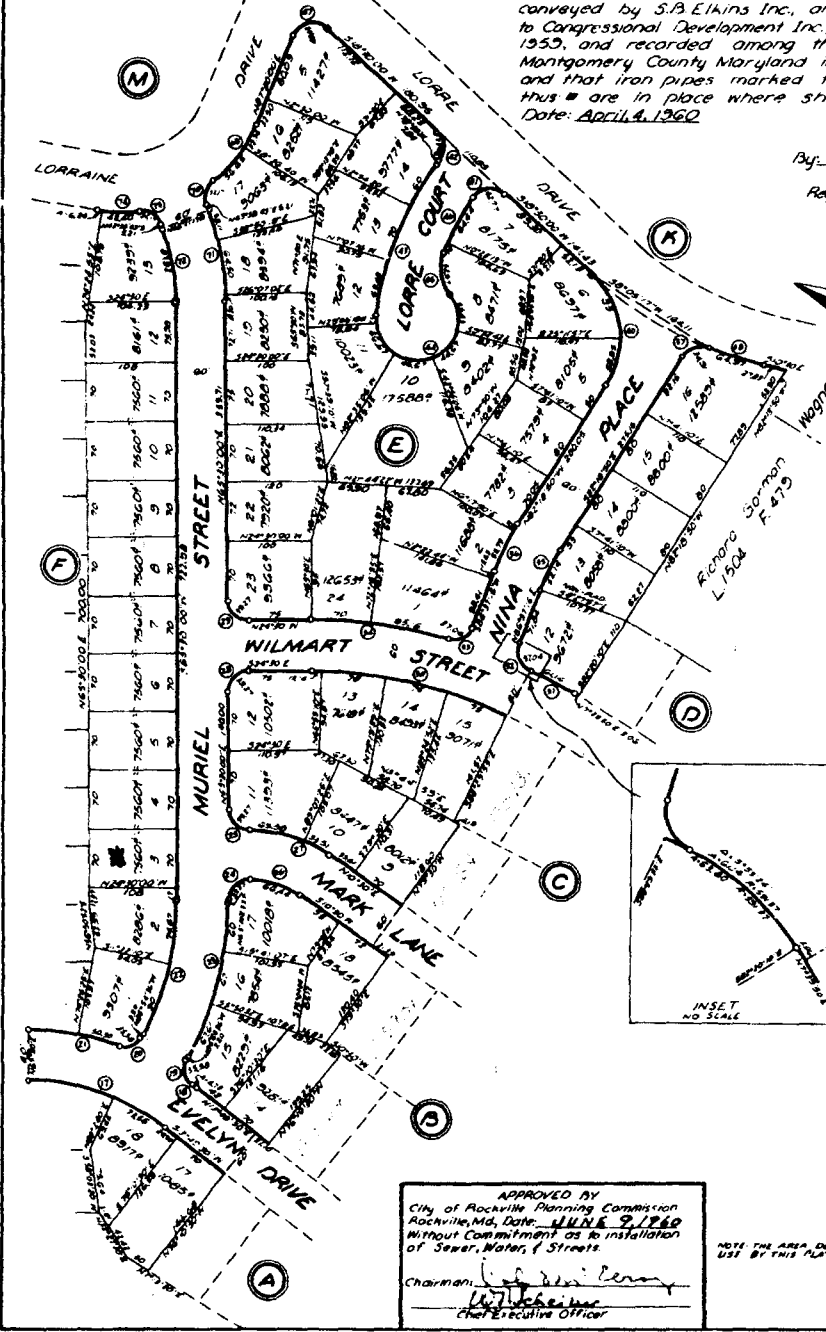

OWNER'S DEDICATION

We, Congressional Development Inc., a Maryland Corporation by Milton Polinger, President, and Stanley Rakusin, Secretary, owners of the property shown hereon, hereby adopt this plan of subdivision, establish the minimum building restriction lines, and dedicate the streets to public use.

Date: April 4, 1960
Congressional Development Inc.
Attest: Stanley Rakusin By: Milton Polinger
Stanley Rakusin, Secy. Milton Polinger, Pres.

We assent to this plan of subdivision
Edith P. Brown Brockett Muir
Witness Brackett Muir, trustee
John P. Brown J. Robert Marygraff
Witness J. Robert Marygraff, trustee

FILED

JUN 24 1960

BLOCK - E
AND PARTS OF BLOCKS A, B, C, D, F
MONTROSE
CITY OF ROCKVILLE
MONTGOMERY COUNTY MARYLAND
SCALE 1" = 100' APRIL 1960

KORNEGAY ASSOCIATES, INC.
915 SILVER SPRING AVE.
SILVER SPRING, MD.

APPROVED BY
City of Rockville Planning Commission
Rockville, Md. Date: JUNE 2, 1960
Without Commitment as to installation
of Sewer, Water, & Streets.
Chairman: [Signature]
[Signature]
Chief Executive Officer

NOTE THE AREA DEDICATED TO PUBLIC
USE BY THIS PLAT IS 166,706 S.

MARYLAND STATE ARCHIVES

* = SUBJECT

E.S. / S.N.